

## PORTABLE SCREW COMPRESSOR PDS185S



Control panel



### Main Improvements:

#### ◆ Superior Serviceability

- Newly-designed GULL-WING door - Easiest access to interior inspection and maintenance.
- Filter Cartridge type Separator allows easiest replacement.

#### ◆ Main Components - Maintenance-Free

- New Piston type Automatic-Relief Valve has no diaphragm. Thus servicing of diaphragm is not required any longer.
- Pressure Adjustment Regulator has become smaller and has no diaphragm which need be replaced. It is not necessary to replace diaphragm any longer.

#### ◆ Smooth and Easy Cleaning

- Fittings of oil piping connection have been designed to be O-Ring seat type to eliminate oil leakage.
- Radiator and oil cooler are combined in form of one piece panel so that it provides much more smooth and easier cleaning of radiator and oil cooler.

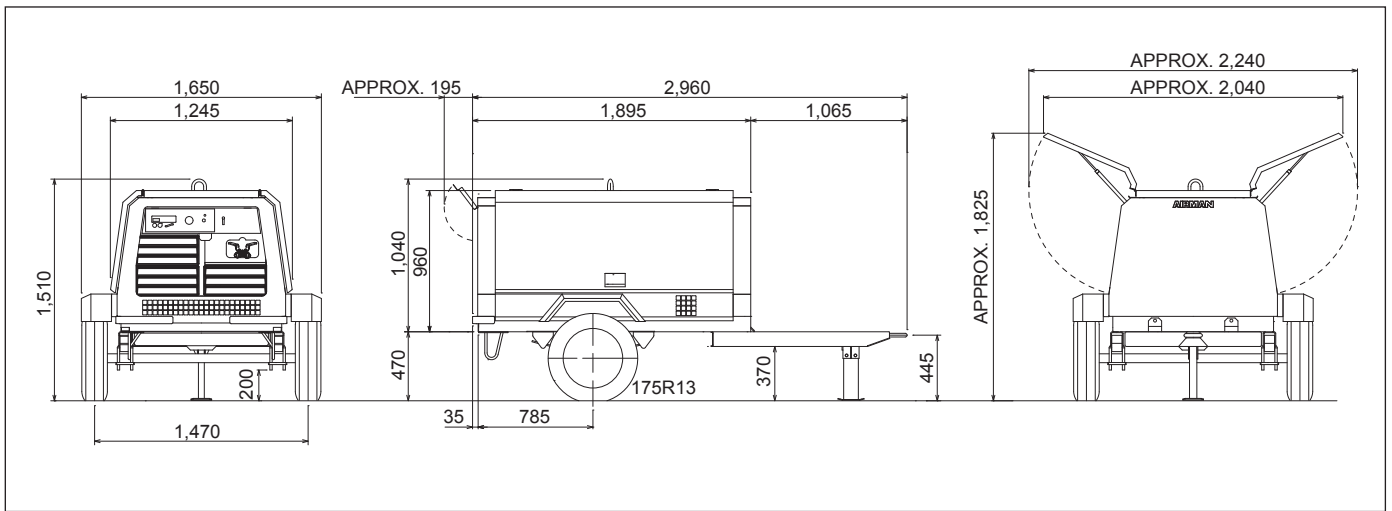

## SPECIFICATIONS PDS185S-6C2

### COMPRESSOR

Type	Rotary twin screw, single stage, oil-cooled
Free air delivery	5.2 m <sup>3</sup> /min(185 cfm)
Working pressure	0.69MPa(7 kgf/cm <sup>2</sup> G)(100 psi)
Unloader	Suction port closing in connection with stepless speed regulator
Lubrication system	Forced lubrication by compression pressure
Driving system	Direct coupling with gears
Oil cooling	Air-cooled
Air cleaner	Dry paper filter type

### DIESEL ENGINE

Model	YANMAR 4TNV88-BDHS
Type	Water-cooled, 4-cycle, direct injection type
No. of cylinders	4
Cyl. bore X stroke	88 mm x 90 mm
Total displacement	2.189 liters
Compression ratio	19.0 : 1
Rated output	36.4 kW/3,000 min <sup>-1</sup> (49.5 PS/3,000 rpm)
Middle torque	140.8 Nm/approx. 1,800min <sup>-1</sup> (14.4 kgf-m/approx. 1,800 rpm)
Injection pump	Yanmar VE pump type
Governor	Centrifugal, all-speed
Alternator	DC 12 V, 40 A
Starting motor	DC 12 V, 1.7 kW
Battery	80D26R-MF(NX110-5MF)x1 pc.
Air cleaner	Dry type
Fuel tank capacity	90 liters
Engine oil capacity(including oil cooler)	7.4 liters
Coolant capacity(including engine radiator)	5.8 liters
Compressor oil capacity(including receiver tank & oil cooler)	15 liters

### OIL SEPARATOR-RECEIVER TANK

Type	Vertical, cylindrical, full-welded
Shell dia.	φ226.4 mm
Shell length	594 mm
Capacity	0.021 m <sup>3</sup>
Max. working pressure	1.38 MPa(14.1 kgf/cm <sup>2</sup> G)
Hydraulic test pressure	1.8 MPa(18.4 kgf/cm <sup>2</sup> G)
Air outlet valve	20 A x 2 pcs.

### INSTRUMENTS & GAUGES

#### EMERGENCY STOP DEVICES

Engine oil pressure switch , Delivery air temperature switch ,  
Engine coolant temperature switch ,  
Disconnected of delivery air temperature sensor ,  
Disconnected of engine coolant temperature sensor

#### WARNING LAMP

For engine coolant temperature rise  
For delivery air temperature rise  
For battery charging  
For fuel level down

#### OPERATING LAMP

Glow lamp

#### GAUGES

Pressure gauge , Fuel gauge

#### MONITOR INDICATOR

Delivery air temperature , Engine coolant temperature ,  
Engine speed(rpm) , Hour meter

#### OPERATING SWITCH

Starter switch , Starting unloader valve ,  
Monitor change switch , Error code indication switch

### WEIGHT

Dry weight	860 kgs
Operating weight	960 kgs

## HOKUETSU INDUSTRIES CO., LTD.

8TH Floor Shinjuku San-Ei Bldg,  
22-2 Nishi-Shinjuku 1-Chome, Shinjuku-ku, Tokyo 160-0023 Japan  
TEL:81-3-3348-7281 FAX:81-3-3348-7289  
E-mail:oversea@airman.co.jp  
http://www.airman.co.jp

## HOKUETSU INDUSTRIES EUROPE B.V.

Breguetlaan 12, 1438 BC Oude Meer, The Netherlands  
PHONE:31-20-6462636 FAX:31-20-6462191  
e-mail:info@hokuestu.nl

**SAFETY**

- Operate safely in accordance with proper operation manual.
- To prevent trouble and accidents, perform daily and preventive maintenance checks without fail.



ISO9001 : JQA-0581  
ISO14001 : JQA-EM4670